

# Hydra-Cell®

## Industrial Pumps

### C80 Airbleed Priming Valve

- *Easy installation*
- *Mounts vertically or horizontally*
- *Allows pump to prime by quickly relieving the system of trapped vapors*
- *Automatically opens when air is present*
- *Available in a variety of materials of construction*
- *Compatible with Wanner F/G-20 thru D/G-12 Series Hydra-Cell pumps*

**New  
Accessory!**



**WANNER ENGINEERING INC**

## An Effective Air/Vapor Release Mechanism for Diaphragm Pump Systems

The Wanner Engineering Airbleed Priming Valve creates an open port to atmosphere for the pumping system. The valve allows the pump to clear air (or vapors) from the pump head and discharge plumbing rather than compressing the gas and reducing flow. Automatically opening to clear gas as it becomes present, the valve then closes to develop immediate full system pressure. The valve operates in systems with a minimum of 75 psi (5 bar) back pressure. The C80 Airbleed Valve can be mounted either in a vertical or horizontal configuration ( $\pm 90^\circ$  from the upright position). The T-fitting must be mounted in the upright position as illustrated.

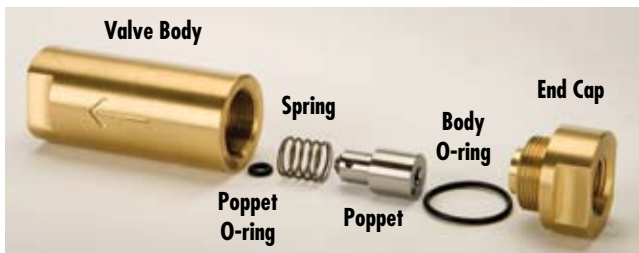

### Specifications

<b>Inlet/Outlet Ports</b>	3/8" NPT
<b>Flow Range</b>	1.5 to 10 GPM (5-37 l/min)
<b>Max Temperature</b>	200°F
<b>Minimum Discharge Pressure Required</b>	75 psi (5 bar)
<b>Pressure Range:</b>	
<b>Metal Units</b>	75-2500 psi (5 to 172 bar)
<b>Non-Metal Units</b>	75-250 psi (5 to 17 bar)
<b>O-ring</b>	Buna, Viton, Neoprene, EPDM
<b>Internal Wetted Parts</b>	Hastelloy C

### Dimensions

in (mm)

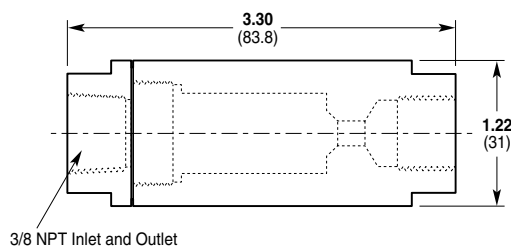

# C80 Airbleed Priming Valve

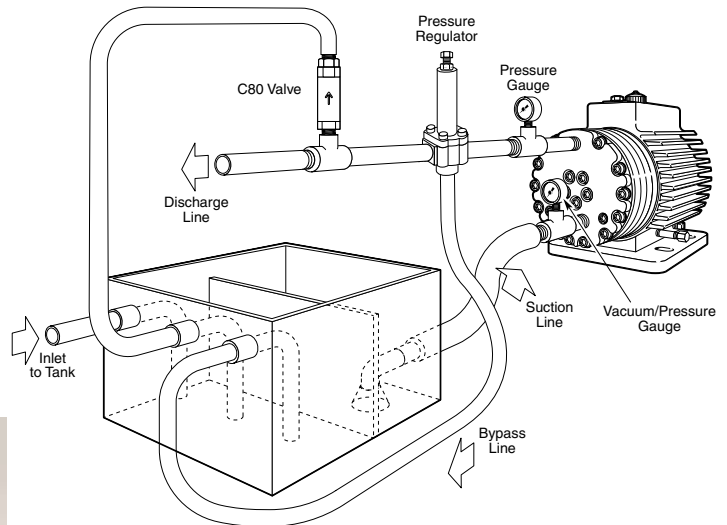

Order Digit	Code	Description
<b>1-4</b>		<b>Valve Configuration</b>
	<b>C80A</b>	1.5 to 10 gpm (5-37 l/min)
<b>5</b>		<b>Flow Range</b>
	<b>A</b>	1.5-3 GPM (5-11 l/min)
	<b>B</b>	2.5-5 GPM (9-19 l/min)
	<b>C</b>	4.5-7 GPM (17-26 l/min)
	<b>D</b>	6.5-10 GPM (24-37 l/min)
<b>6</b>		<b>Body Material</b>
	<b>B</b>	Brass
	<b>M</b>	Kynar
	<b>S</b>	316 Stainless Steel
<b>7</b>		<b>O-rings</b>
	<b>E</b>	EPDM
	<b>G</b>	Viton
	<b>P</b>	Neoprene
	<b>T</b>	Buna
<b>8</b>		<b>Poppet Material</b>
	<b>H</b>	Hastelloy® C276
<b>9</b>		<b>Spring Material</b>
	<b>H</b>	Hastelloy® C276
<b>10</b>		<b>Seat Size</b>
	<b>E</b>	For C80 Models
<b>11</b>		<b>Port Size</b>
	<b>E</b>	For C80 Models (3/8" NPT)



### Wanner Engineering, Inc.

1204 Chestnut Avenue, Minneapolis, MN 55403 USA  
 (612) 332-5681 FAX (612) 332-6937  
 Toll Free FAX (USA only) (800) 332-6812  
 Email: sales@wannereng.com  
 Website: www.hydra-cell.com

Printed in USA 11.15.05



### Wanner International Ltd.

Units 8 & 9, Fleet Business Park, Sandy Lane  
 Church Crookham, Hampshire GU52 8BF, England  
 Tel +(44) 01252 816847  
 FAX Tel +(44) 01252 629242  
 Email: sales@wannerint.com